

Beginning at a Post  
 Thence N. 80 W. 13 1/2 post  
 S. 5 W. 20 post  
 South 20 Red oak  
 S. 9 W. 10 W.O.  
 S. 2 E. 10 1/2 Red oak  
 S. 68 E. 2 Red oak  
 S. 15 E. 21 B.O.  
 N. 13 E. 41 1/2 the  
 place of begin<sup>g</sup>

Peter Vandevenders other Land

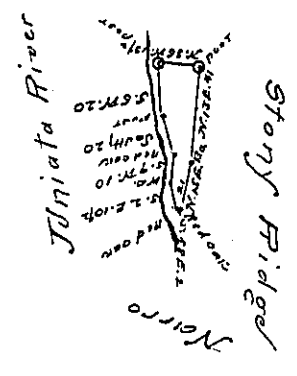

The Draught of a Tract of Land Situate on  
 the North side of Juniata River Joining said River  
 & Joining Stony Ridge and Peter Vandevenders  
 other Land in Huntingdon County & Township  
 Containing two Acres one Hundred and Fifty seven  
 1/2 Perches <sup>with usual allowance</sup> Surveyed the 12<sup>th</sup> Day of October 1793 in Pursuance  
 of a Warrant to Peter Vandevender Dated  
 the 24<sup>th</sup> of June 1788.

Daniel Brodhead Esquire J. J.      John Canan Esq.

IN TESTIMONY that the above is a copy of the original remaining on file in the  
 Department of Internal Affairs of Pennsylvania, made conformably to an Act of Assembly approved the 16th day of  
 February, 1833, I have hereunto set my Hand and caused  
 the Seal of said Department to be affixed at Harrisburg, this  
 — SIXTY — day of — JUNE — 1895.

James W. Fatta  
 Secretary of Internal Affairs.